

9. Place of use:

DOMESTIC within KOOTENAI County

Township	Range	Section	¼	of	¼	Lot	Acres
52N	05W	28	SE		SE	1	

10. Do you own the property listed above as place of use? Yes

If your answer is no, describe in remarks below the authority you have to claim this water right.

11. Other Water Rights Used:

12. Remarks:

Priority Date Explanation:

TAX PARCEL YEAR BUILT (1984), WELL COMPLETION DATE (10/21/2004)

13. Basis of Claim: Beneficial Use

14. Signature(s)

(a.) By signing below, I/We acknowledge that I/We have received, read and understand the form entitled "How you will receive notice in the COEUR D'ALENE-SPOKANE River Basin Adjudication." (b.) I/We do _____ do not wish to receive and pay a small annual fee for monthly copies of the docket sheet.

Number of attachments: 1

For Individuals:

I/We do solemnly swear or affirm under penalty of perjury that the statements contained in the foregoing document are true and correct.

Signature of Claimant(s): *Robert Meyer* Date: 5-13-25

Date: _____

IDAHO DEPARTMENT OF WATER RESOURCES
WELL DRILLER'S REPORT

Office Use Only
Inspected by _____
Twp 1/4 Rge 1/4 Sec 1/4
Lat: : : Long: : :

1. DRILLING PERMIT NO. _____
Other IDWR No. D 0035504

2. OWNER: 825435
Name Harry Rogers
Address 13325 W. Biggs Road
City Rathdrum State ID Zip 83858

3. LOCATION OF WELL by legal description:
Sketch map location must agree with written location
N

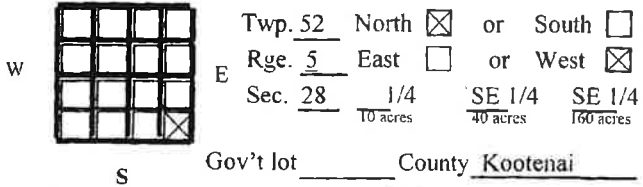

Lat: 47:49:090 Long: 116:57:657
Address of Well Site top of Biggs Road
City Rathdrum
(Give at least name of road + Distance to Road or Landmark)
Lt. _____ Blk. _____ Sub. Name _____

4. USE:
 Domestic Municipal Monitor Irrigation
 Thermal Injection Other _____

5. TYPE OF WORK check all that apply (Replacement etc.)
 New Well Modify Abandonment Other _____

6. DRILL METHOD
 Air Rotary Cable Mud Rotary Other _____

7. SEALING PROCEDURES

SEAL/FILTER PACK		AMOUNT		METHOD
Material	From	To	Sacks or Pounds	
Bentonite	0	19	400#	dry granular

Was drive shoe used? Y N Shoe Depth(s) 47'
Was drive shoe seal tested? Y N How? _____

8. CASING/LINER:

Diameter	From	To	Gauge	Material	Casing	Liner	Welded	Threaded
6"	+2	47	250	Steel	<input checked="" type="checkbox"/>	<input type="checkbox"/>	<input checked="" type="checkbox"/>	<input type="checkbox"/>
4"	20	500	s 40	PVC	<input type="checkbox"/>	<input checked="" type="checkbox"/>	<input type="checkbox"/>	<input type="checkbox"/>
					<input type="checkbox"/>	<input type="checkbox"/>	<input type="checkbox"/>	<input type="checkbox"/>

Length of Headpipe _____ Length of Tailpipe _____

9. PERFORATIONS/SCREENS
 Perforations Method saw cut 1/8" x 6" slot
 Screens Screen Type _____

From	To	Slot Size	Number	Diameter	Material	Casing	Liner
480	500	1/8	33	4"	PVC	<input type="checkbox"/>	<input checked="" type="checkbox"/>
						<input type="checkbox"/>	<input type="checkbox"/>
						<input type="checkbox"/>	<input type="checkbox"/>

10. STATIC WATER LEVEL OR ARTESIAN PRESSURE:
25 ft. below ground Artesian Pressure _____ lb
Depth flow encountered _____ ft. Describe access port or control devices: _____

11. WELL TESTS:
 Pump Bailer Air Flowing Artesian

Yield gal/min	Drawdown	Pumping Level	Time
5 gpm			

Water Temp. _____ Bottom hole temp. _____
Water Quality test or comments: Cold & clear
Depth first Water Encountered 97'

12. LITHOLOGIC LOG: (Describe repairs or abandonment)

Water

Bore Dia.	From	To	Remarks: Lithology, Water Quality & Temp.	Y	N
10"	0	18	Silt, sand, brown		
8"	18	23	Silt, sand, brown		
	23	32	Shale, soft, decomposed lenses		
	32	47	Shale, medium and soft		
6"	47	62	Shale, tan, medium		
	62	87	Shale, black, white, soft		
	87	89	Silt, brown, soft		
	89	97	Shale, white, green, quartz		
	97	132	Shale, white, green, medium		
	132	137	Shale, black, white, rose		
	137	139	Shale, pink, green, quartz		
	139	145	Shale, black, white, rose, mica		
	145	149	Shale, green, white, soft		
	149	178	Shale, grey, green, white, medium		
	178	193	Shale, white, green, hard		
	193	200	Shale, green, black, white		
	200	228	Shale, green, white		
	228	260	Shale, green, white, black		
	260	262	Quartz, white		
	262	322	Shale, green, white, black, medium		
	322	330	Shale, green, black		
	330	342	Shale, black		
	342	382	Shale, green, black		
	382	387	Quartz, white		
	387	462	Shale, black, white		
	462	472	Shale, grey with quartz, soft		
	472	480	Quartz, purple		
	480	498	Shale, black, white, green		
	498	500	Shale, soft, green		

Completed Depth: 500 (Measurable)
Date: Started 10/18/04 Completed 10/21/04

13. DRILLER'S CERTIFICATION

I/We certify that all minimum well construction standards were complied with at the time the rig was removed.

Firm Name McCarty Drilling & Pump Inc Firm No. 586

Firm Official [Signature] Date 10-26-04

Supervisor or Operator _____ Date _____
(Sign once if Firm Official & Operator)

Date: 10/26/2004 Time: 8:10 AM

52N 5W 28